

**HYDROGARD**  
WATERPROOFING  
COMPOSITE

**ENKADRAIN®**  
DRAINAGE COMPOSITE

SEALANT BETWEEN  
SLEEVE AND WALL

CLAMPING RING  
(OPTIONAL)

BACKFILL

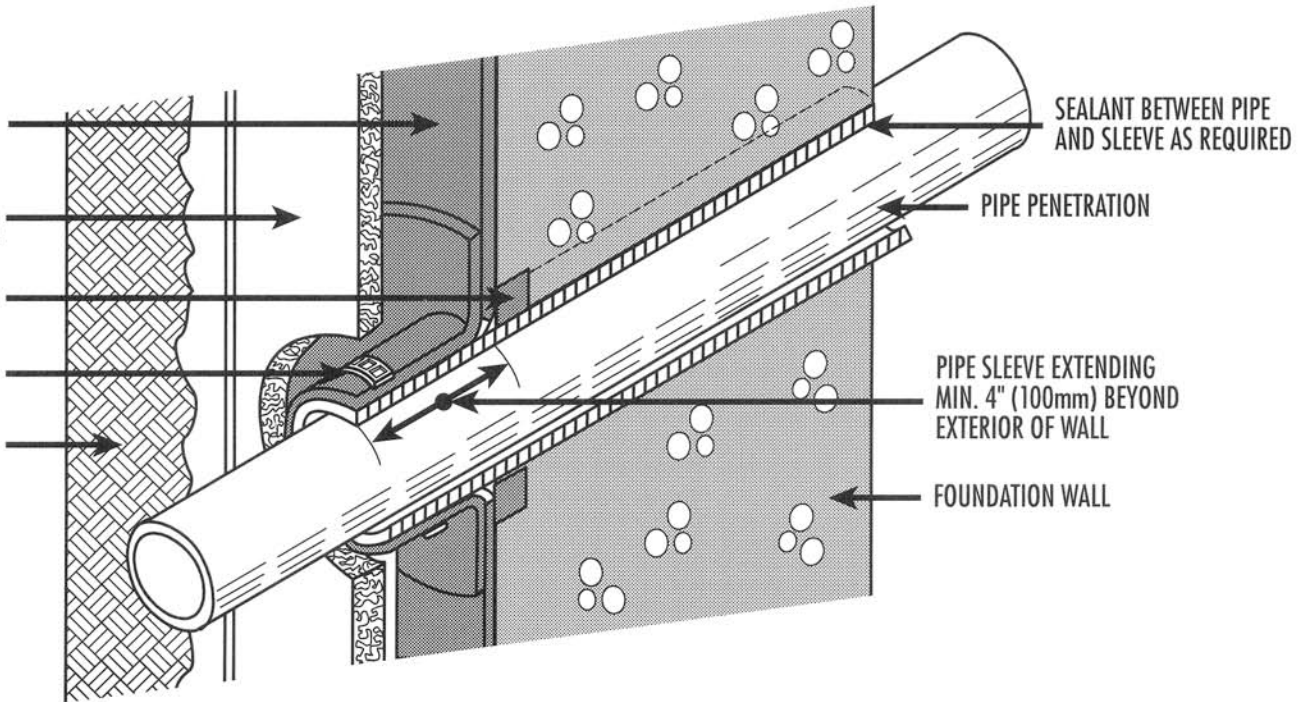

SEALANT BETWEEN PIPE  
AND SLEEVE AS REQUIRED

PIPE PENETRATION

PIPE SLEEVE EXTENDING  
MIN. 4" (100mm) BEYOND  
EXTERIOR OF WALL

FOUNDATION WALL